



# HTX6H/STX6H Ride-On Power Trowel

## Deep Sea Display Service Kit Instructions

The following instructions are intended to assist the user with the installation of the Deep Sea Display Service Kit for use on a Multiquip model HTX6H or STX6H ride-on power trowel. Please read all assembly instructions before installing the kit.

### REQUIRED TOOLS

- Marking pen
- Power drill with 1/4" drill bit
- 7/16" socket
- 3.25" bi-metal or carbide-tipped hole saw attachment
- File, sanding tool, and/or deburring tool

### PARTS

Verify that all parts are accounted for.  
See Table 1 and Figure 1.

Table 1. Deep Sea Display Service Kit				
Item	Part No.	Description	Qty.	Remarks
1	42748-SK	Kit, Display, Murphy to Deep Sea, HTX-STX6H	1	Includes items 2-8
2	48369	Display, Deep Sea DSE050, HTX-STX6H	1	
3	49048	Screw, HHFS 1/4-20 × 3/4 Gr 5	2	
4	52233	Guide, Top, Deep Sea Display, HTX-STX6H	1	
5	52234	Guide, Btm Asm, Deep Sea, HTX-STX6H	1	Includes item 6
6	19266	Nut, Blind 1/4-20 × .027-.165	2	
7	48368	Harness, Deep Sea Display, HTX-STX6H	1	
8	52236	Instructions, Deep Sea Display Kit, HTX-STX6H	1	

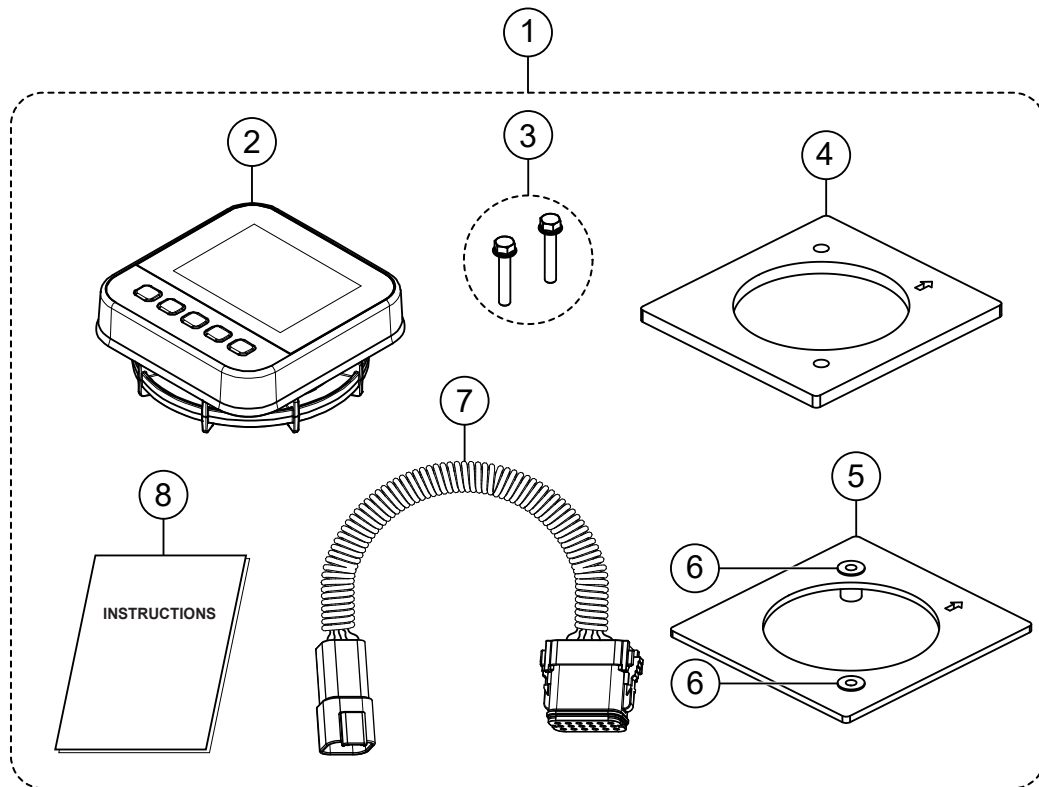

Figure 1. Deep Sea Display Service Kit

## WORK SAFELY!

Only a **qualified service technician** with proper training should perform this installation. **Follow all shop safety rules** while performing this installation.

## PREPARATION

1. Place the trowel on secure, level ground in an area that is free of dirt and debris.
2. Make sure the trowel is turned **OFF** and the engine is cool.
3. Disconnect the negative (**BLACK**) battery cable from the negative (–) battery terminal.

## MURPHY DISPLAY REMOVAL

1. Reach inside the console frame near the **right-side lift handle** (Figure 2) and disconnect the **right-hand console wire harness** from the **Murphy display**.

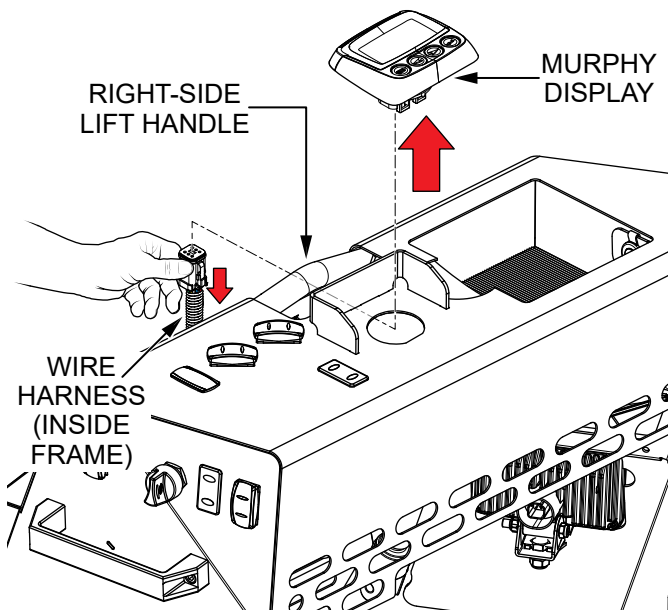
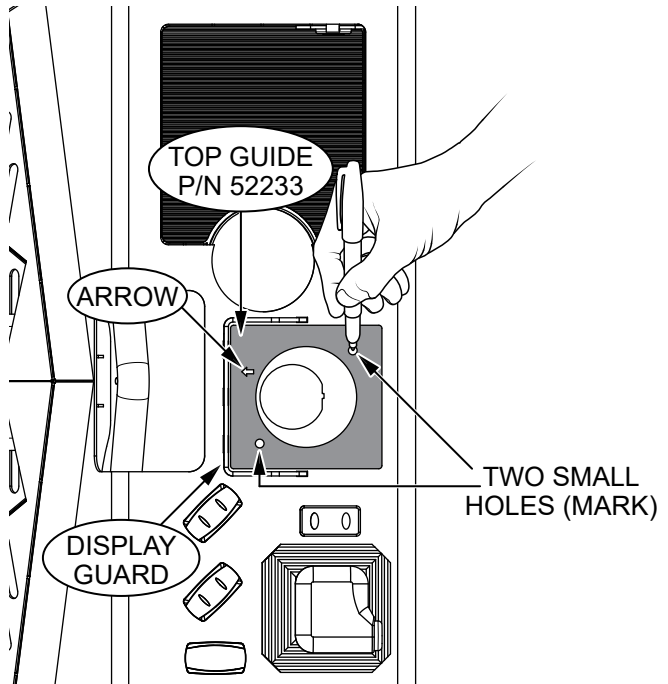

**Figure 2. Remove Murphy Display**

2. Unscrew the fastening ring securing the Murphy display (Figure 2) to the console and lift the display out of the hole in the frame.
3. Remove any debris that may be present in the display area.

## CUTTING TEMPLATE INSTALLATION

1. Place the **top guide (P/N 52233)** inside the **display guard** with the **arrow** pointing away from the seat as shown in Figure 3. Press the top guide against the long edge of the display guard, and align it equidistant between the two short edges of the display guard. Make sure the arrow is closer to the **rear** edge of the display guard.



**Figure 3. Top Guide Placement**

2. Use a marking pen (Figure 3) to mark the location of the two small holes, then remove the top guide (P/N 52233).

3. Use a power drill with a 1/4-inch drill bit to drill a hole into the console frame at each of the two marked locations (Figure 4). Be sure to remove any debris that remains from the drilling.

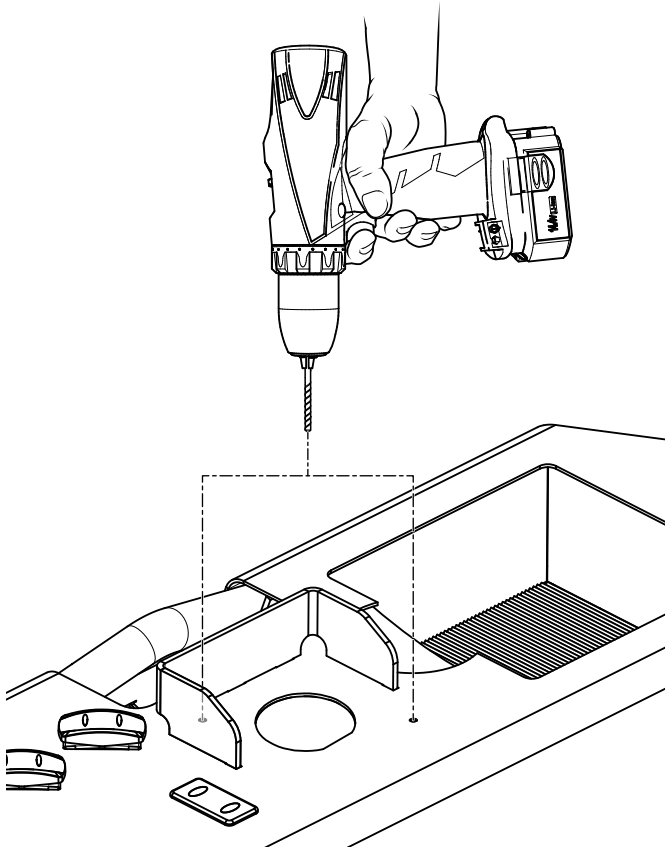

**Figure 4. Drill Two New Holes**

4. Slide the **bottom guide (P/N 52234)** into the opening near the **right-side lift handle**, with the arrow pointing away from the seat and the heads of the **blind nuts (P/N 19266)** facing upward. See Figure 5.

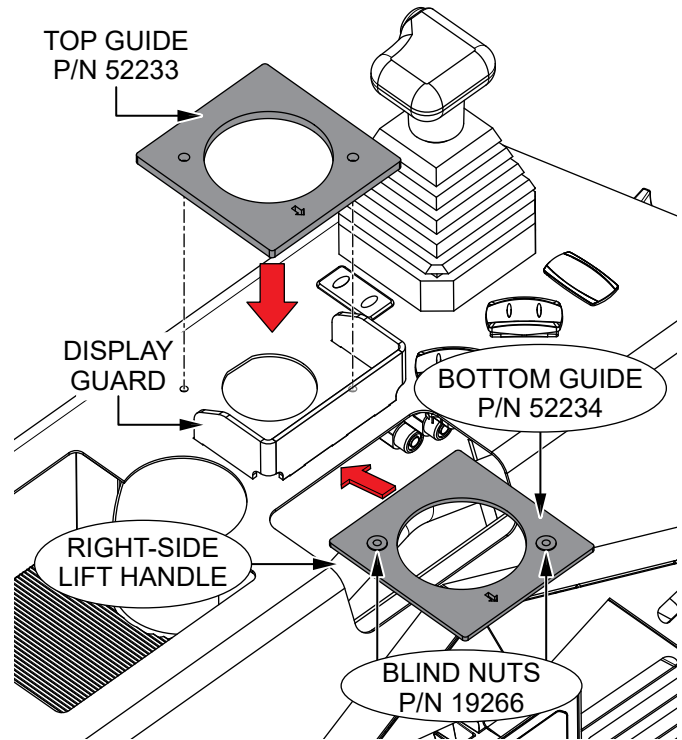

**Figure 5. Top And Bottom Guide Placement**

5. While holding the bottom guide (P/N 52234) in place, return the **top guide (P/N 52233)** to its previous position inside the **display guard**. Make sure the arrow is pointing away from the seat and the holes are aligned with the holes that were drilled in step #3. See Figure 5.

6. Press the **bottom guide (P/N 52234)** flat against the console frame. Make sure the **two blind nuts (P/N 19266)**, the two newly drilled holes, and the two holes in the **top guide (P/N 52233)** are all aligned. The arrow in the top guide and the arrow in the bottom guide should also be aligned. See Figure 6.

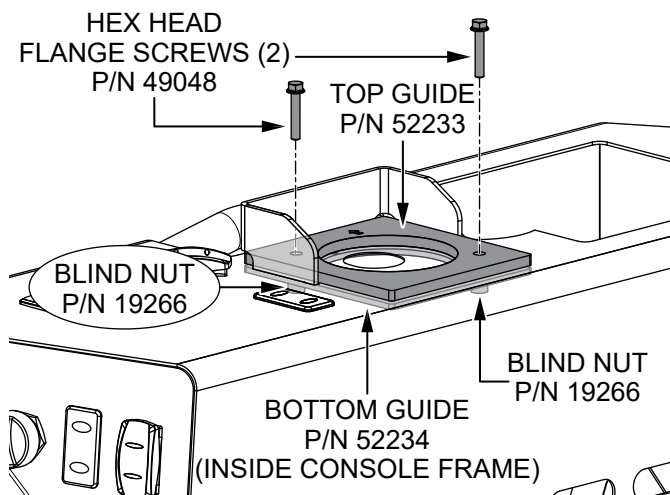

**Figure 6. Fasten Top And Bottom Guides Together**

7. Secure the top guide (P/N 52233) to the bottom guide (P/N 52234) with the **two hex head flange screws (P/N 49048)**. See Figure 6.

## NEW HOLE CREATION

1. Using the **top guide (P/N 52233)** and **bottom guide (P/N 52234)** as a cutting template (Figure 7), cut a new hole into the frame with a 3.25-inch hole saw attachment.

### NOTICE

**MAKE SURE** the hole saw attachment is rated for cutting steel. A bi-metal or carbide-tipped hole saw is recommended.

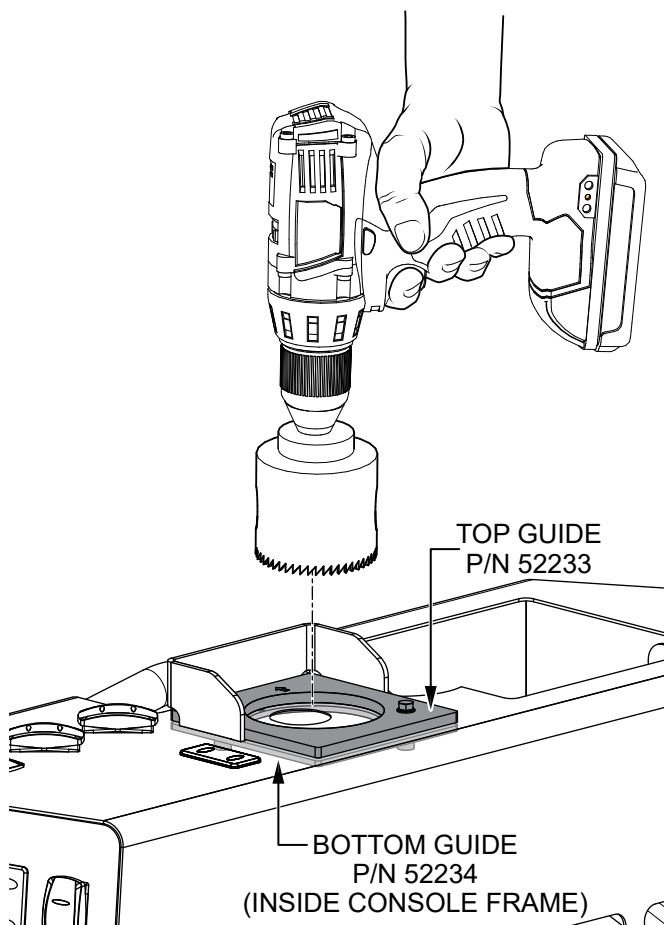
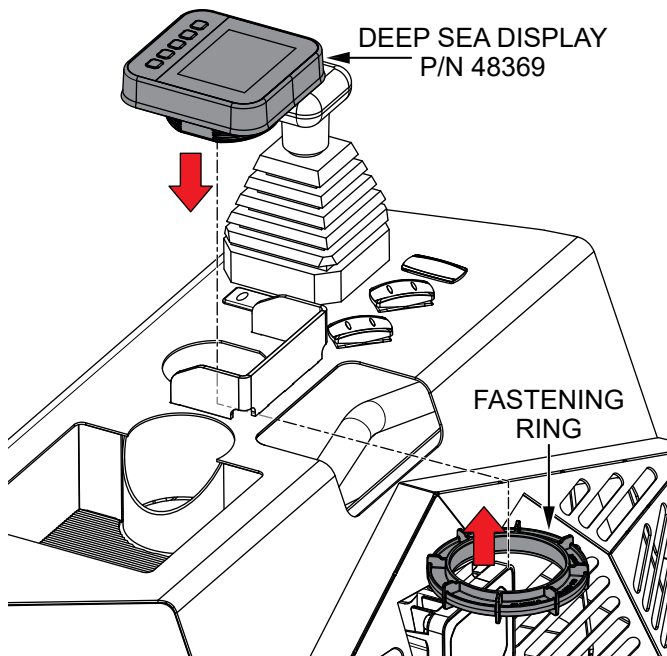

**Figure 7. Cut New Hole**

2. Remove the two hex head flange screws (P/N 49048) securing the top guide (P/N 52233) and the bottom guide (P/N 52234) to the console frame, then remove the top guide and the bottom guide.
3. Using a file, sanding tool, or deburring tool, remove any sharp edges or burrs that may have been created during the cutting process. Clean up any debris that may have fallen into the machine.

## DEEP SEA DISPLAY INSTALLATION

1. Remove the **fastening ring** from the **Deep Sea display (P/N 48369)**. See Figure 8.



**Figure 8. Install Deep Sea Display**

2. Place the Deep Sea display (P/N 48369) into the new hole with the buttons facing toward the seat. See Figure 8.
3. Use the fastening ring (Figure 8) to secure the display to the frame. Tighten the fastening ring until it is snug.

### NOTICE

**DO NOT** overtighten the fastening ring, as this may damage the plastic threads.

4. Locate the **right-hand console harness connector P4** that was unplugged earlier from the Murphy display and connect it to **connector J1** on the **Deep Sea display harness (P/N 48368)**. See Figure 9.

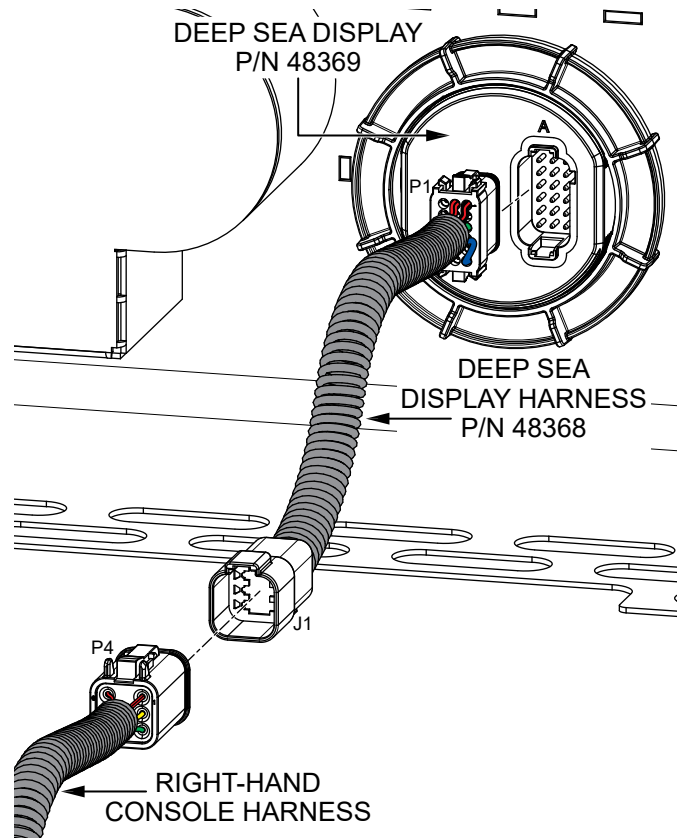

**Figure 9. Connect Wiring Harness**

5. Plug **connector P1** on the Deep Sea display harness (P/N 48368) into the back of the **Deep Sea display (P/N 48369)**. See Figure 9.

## DEEP SEA DISPLAY OPERATION

For details on the operation of your new Deep Sea display, refer to the **HTX6H/STX6H (S/N NM2005211 and Above) Operation Manual** which can be found at: [www.multiquip.com](http://www.multiquip.com).



# HTX6H/STX6H Ride-On Power Trowel

## Deep Sea Display Service Kit Instructions

---

## HERE'S HOW TO GET HELP

PLEASE HAVE THE MODEL AND SERIAL  
NUMBER ON-HAND WHEN CALLING

### UNITED STATES

#### *Multiquip Inc.*

(310) 537- 3700  
6141 Katella Avenue Suite 200  
Cypress, CA 90630  
E-MAIL: [mq@multiquip.com](mailto:mq@multiquip.com)  
WEBSITE: [www.multiquip.com](http://www.multiquip.com)

---

### CANADA

#### *Multiquip*

(450) 625-2244  
4110 Industriel Boul.  
Laval, Quebec, Canada H7L 6V3  
E-MAIL: [infocanada@multiquip.com](mailto:infocanada@multiquip.com)

### UNITED KINGDOM

#### *Multiquip (UK) Limited Head Office*

0161 339 2223  
Unit 2, Northpoint Industrial Estate,  
Globe Lane,  
Dukinfield, Cheshire SK16 4UJ  
E-MAIL: [sales@multiquip.co.uk](mailto:sales@multiquip.co.uk)

© COPYRIGHT 2025, MULTIQUIP INC.

Multiquip Inc. and the MQ logo are registered trademarks of Multiquip Inc. and may not be used, reproduced, or altered without written permission. All other trademarks are the property of their respective owners and used with permission.

DISCLAIMER: Product features, descriptions, and specifications are based on published information at the time of publication and are subject to change at any time without notice. Multiquip Inc. and its affiliates reserve the right to change specifications, features, design, and descriptions of products at any time without notice.



**PN: 52236**