



QP303H

MULTIQUIP® 3" Centrifugal Pump

GALLONS PER MINUTE

245 (927 L)

HEAD

98 ft (29.8 M)

ENGINE

Honda GX160



APPLICATIONS

Agricultural - Construction Sites - Emergency Response - Excavation - Farms - Floods - Irrigation - Jobsite - Drainage - Mining - Municipalities - Standing Water - Swimming Pools - Quarries - Water Departments - Water Supply from Lakes/Rivers

STANDARD FEATURES

- Maximum pumping capacity of **245 gallons (927 liters) per minute.**
- Maximum lift of **25 feet (7.6 meters).**
- Aluminum body with cast-iron fittings.
- High-Efficiency impeller and volute for maximum fluid transfer.
- **Cast Iron impeller and volute** for abrasion resistance/long life.
- **Discharge port rotates 180°** for hose orientation.
- Ceramic carbide mechanical seal provides **extreme abrasion resistance** and **high temperature operation.**
- 1" (25.4 mm) diameter fill and drain ports.
- Engine oil-alert to protect the engine in the case of low engine oil.
- Heavy duty **0.87" (22.2 mm) tubular steel frame** for transportation and pump protection.

WARRANTY*

QP303H: 24 months from date of purchase.

Honda GX160 Engine: 36 months from date of purchase.

Hoses: 3 months from date of purchase.

*Refer to the MULTIQUIP NEW PRODUCT LIMITED WARRANTY FOR FULL TERMS AND CONDITIONS.

FEATURES

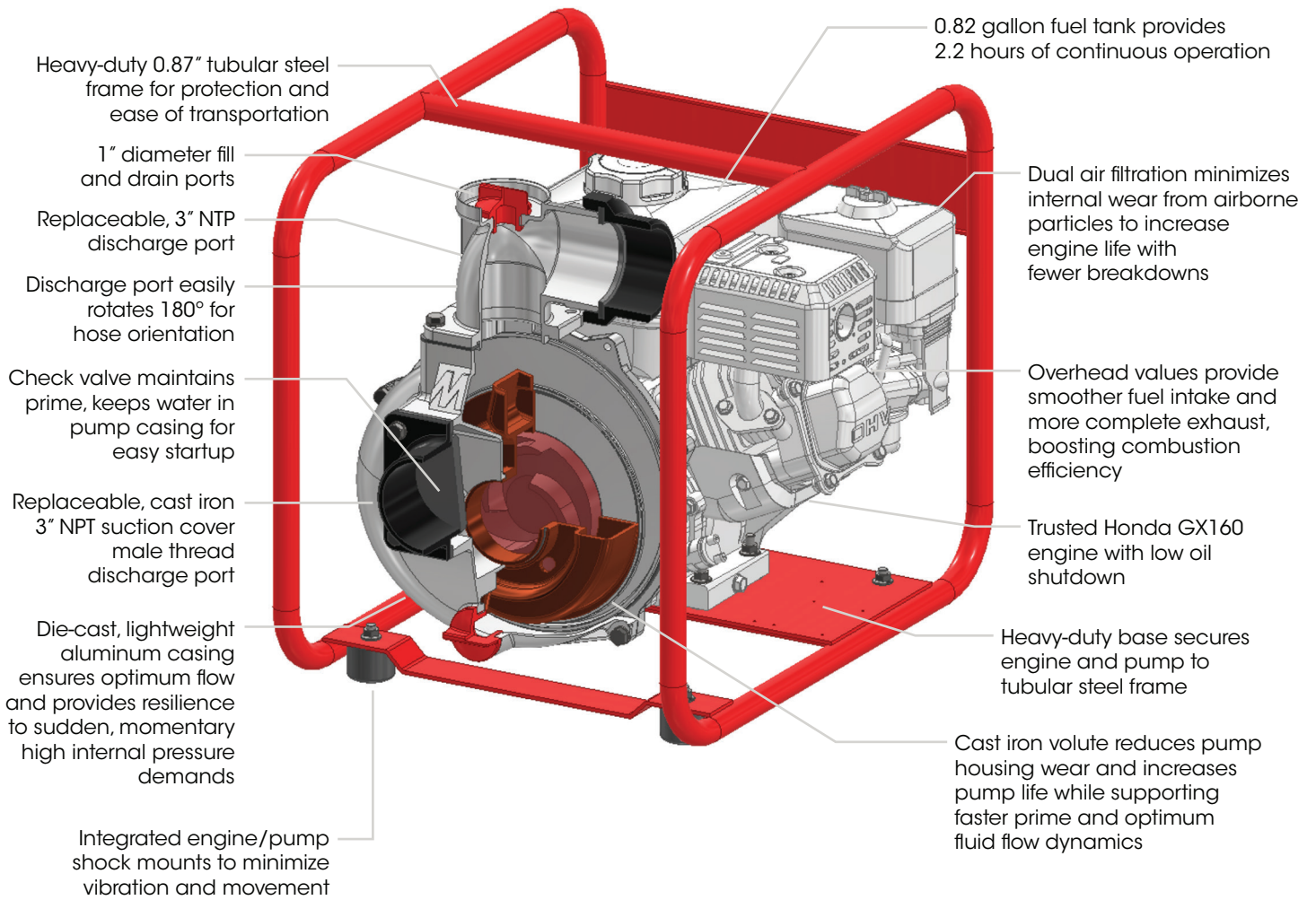

3 vane impeller for enhanced performance and high efficiency

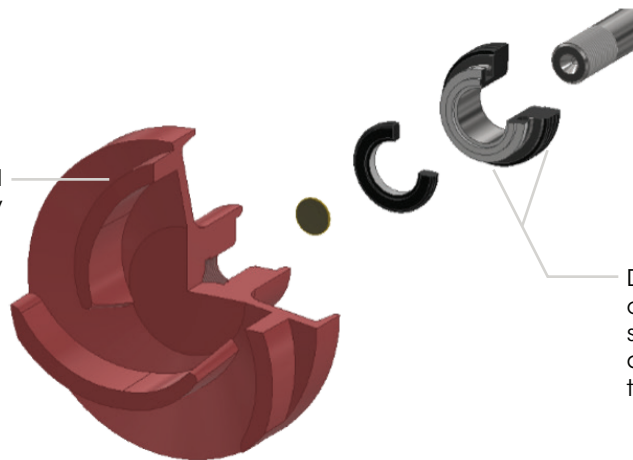

Durable mechanical seal made of silicon carbide and 304 stainless steel to meet the rigorous demands of abrasion and high temperature operation

PUMP CURVE

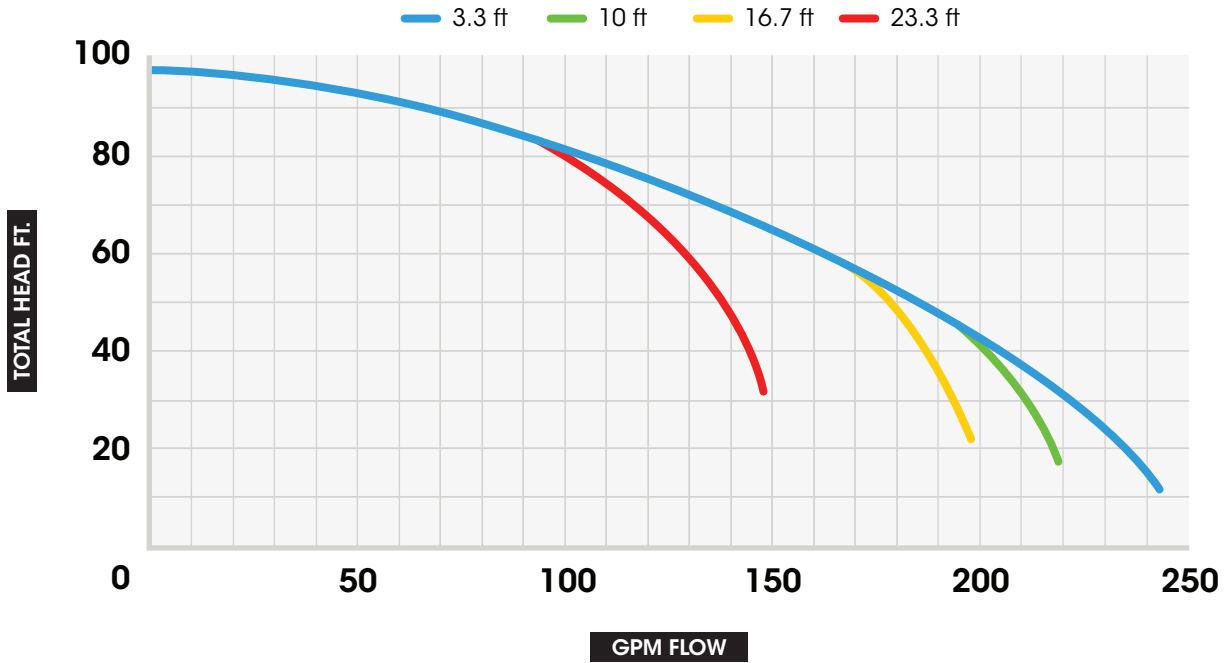

PUMP DIMENSIONS

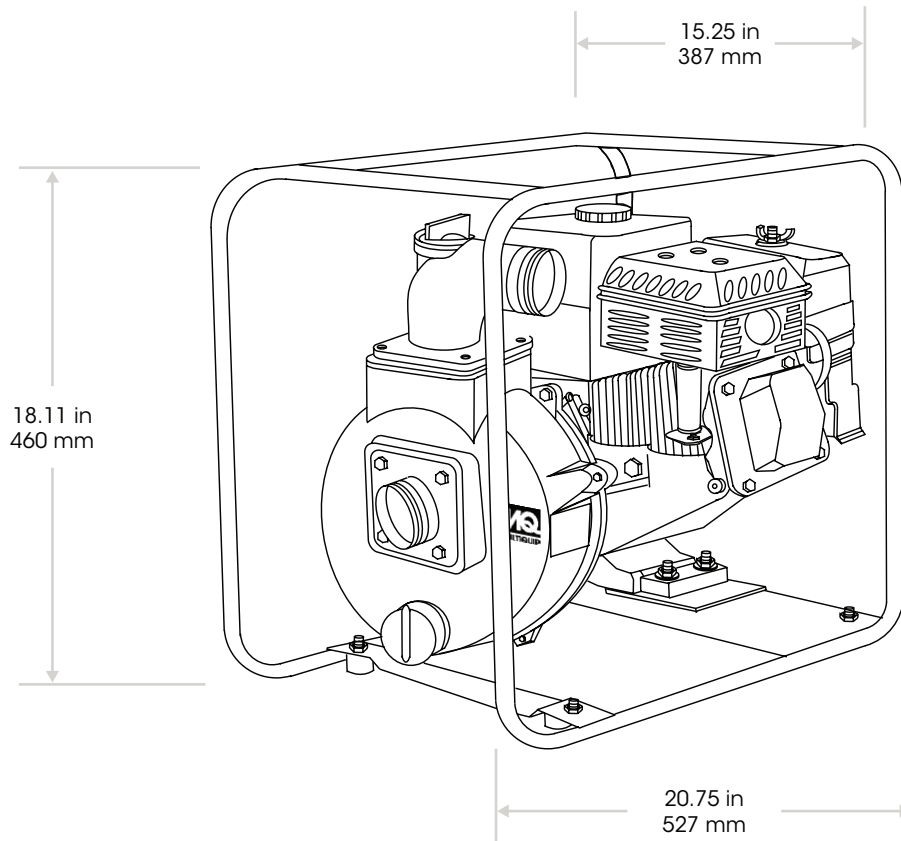

SPECIFICATIONS

PUMP SPECIFICATIONS	
MODEL	QP303H
TYPE	CENTRIFUGAL PUMP
IMPELLER TYPE	SEMI-OPEN
MAX. PUMP CAPACITY	245 GALLONS/MINUTE (927 L/MIN)
MAX. SUCTION	25 FT (7.62 M)
MAX. HEAD	98 FT (29.8 M)
SUCTION/DISCHARGE PORT SIZE	3 IN (76.2 MM)
THREAD TYPE	NPT (MALE)
PSI	42.4
IMPELLER MATERIAL	CAST IRON
VOLUTE MATERIAL	CAST IRON
PUMP CASING MATERIAL	DIE-CAST ALUMINUM
CHECK VALVE MATERIAL	NITRILE BUTADIENE RUBBER
MECHANICAL SEAL MATERIAL	CERAMIC CARBON 304 STAINLESS STEEL
DRAIN AND FILL CAP MATERIAL	ACRYLONITRILE BUTADIENE STYRENE
SALT OR CHEMICALS	NO
PUMP HARDWARE	STEEL
MAX. FLUID TEMPERATURE	104° F (40° C)
MAX. SOLID HANDLING	0.5 IN (12.7 MM)
O-RINGS	NITRILE BUTADIENE RUBBER
STRAINER SIZE	3 IN (76.2 MM) NPT
STRAINER INLET SIZE	0.35 IN (9 MM)

ENGINE SPECIFICATIONS	
MAKE/MODEL	HONDA/GX160
EMISSIONS	EPA CERTIFIED AND CARB PREEMPT
STARTING METHOD	RECOIL START
DESIGN	AIR-COOLED, 4 STROKE, SINGLE CYLINDER, OHV, HORIZONTAL SHAFT
DISPLACEMENT	163 CC (9.9 CU-IN)
BORE X STROKE	2.7 IN X 1.8 IN (68 MM X 45 MM)
HORSE POWER (kW)	4.8 (3.6)
ENGINE SPEED	3,600 RPM
GOVERNOR SPEED	MECHANICAL
SOUND LEVEL dB(A) AT 23 FT	74
AIR CLEANER	DUAL ELEMENT
LUBRICATION SYSTEM	SPLASH
SPARK ARRESTOR	STANDARD
OIL CAPACITY	0.61 QUARTS (0.58 LITERS)
OIL TYPE	SAE 10W-30
LOW OIL SHUT-DOWN	STANDARD

FUEL SPECIFICATIONS	
RECOMMENDED FUEL	UNLEADED GASOLINE
FUEL TANK CAPACITY	0.82 GALLONS (3.1 L)
FUEL CONSUMPTION	0.37 GPH (1.4 LPH)
RUN TIME	2.2 HOURS

WEIGHT AND DIMENSIONS	
DRY WEIGHT	72.7 LB (33 KG)
DIMENSIONS	20.75 x 15.25 x 18.11 IN (527 x 387 x 460 MM)

OPTIONS

SUCTION HOSES

- **HS320C** – 3" x 20 ft., 65psi, rigid PVC helix reinforced, NPS thread
- **HSQ320C** – 3" x 20 ft., 65psi, rigid PVC helix reinforced, NPT thread, Male Camlock, includes one quick disconnect coupler
- **HS325C** – 3" x 25 ft., 65psi, rigid PVC helix reinforced, NPS thread
- **HSQ325C** – 3" x 25 ft., 65psi, rigid PVC helix reinforced, NPT thread, Male Camlock, includes one quick disconnect coupler
- **A300A** – 3" type A coupler, male quick disconnect x female NPT



HS320C and HS325C

HSQ320C and HSQ325C

DISCHARGE HOSES

- **HD350C** – 3" x 50 ft., 60psi, NPS thread
- **HDQ350C** – 3" x 50 ft., 60psi, NPT thread, includes one quick disconnect coupler
- **A300A** – 3" type A coupler, male quick disconnect x female NPT



HD350C

HDQ350C

A300A

FILTER KIT

- **MKITPUMP-6** – (1) Air cleaner element, (1) spark plug, (5) flooding caps

WHEEL KIT

- **UWKB** – Wheel kit with folding handles and flat free tires for easy transport

NOTICE Features and Specifications are subject to change without notice.