



Water Trailer

Tank Valve Kit Installation

The following instructions are intended to assist the user with the installation of the Tank Valve Kit on a Multiquip WT8 Series or WT5 Series Water Trailer. It is not intended to take the place of the Operation manual shipped with the water trailer. Refer to the Operation manual for safety, operation, and maintenance information. Please read all assembly instructions before installing the kit.

REQUIRED TOOLS

- Ratchet with 5/16" hex socket

PARTS

Verify that all parts are accounted for. See Table 1 and Figure 1.

Table 1. Tank Valve Kit Components				
Item No.	Part No.	Description	Qty.	Remarks
1	59795	Kit, Tank Valve, Water Trailer	1	Includes items 2–11
2	49783	Clamp, Hose, Barrel, 2.2–2.5	2	
3	49908	Hose, Rubber, 2", Suction	1	
4	49907	Handle, WT5C	1	
5	0205	Screw, HHC 3/8-16 × 1.0	1	
6	28290-001	Washer, Fender 3/8 × 1-1/4 Dno	1	
7	49663	Gasket, 2" FP, EPDM, Bnj	2	
8	49664	Clamp, Hose Worm, 2" FP, Bnj	2	
9	49666	Valve, 2" FP, Bnj	1	
10	49900	Fitting, 2" FP × 2" Barb, Trimmed	1	
11	59801	Instructions, Tank Valve Kit Installation, Water Trailer	1	

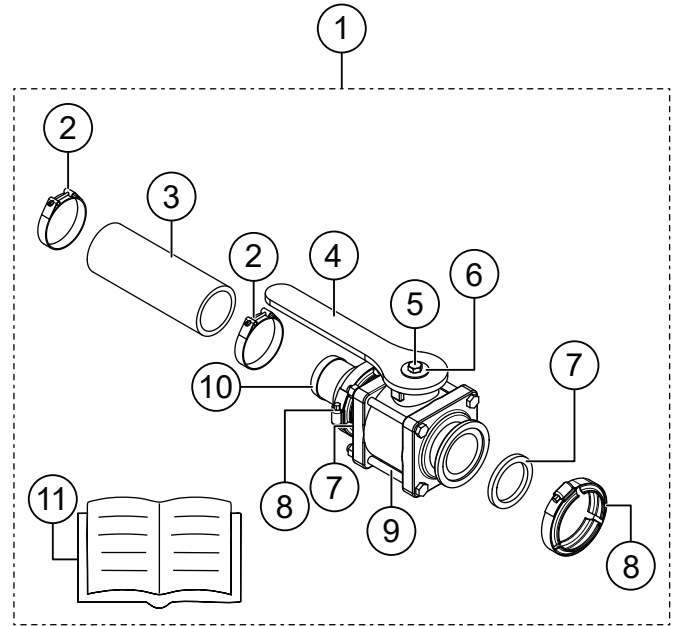

Figure 1. Tank Valve Kit Components

NOTICE

The tank valve kit comes partially pre-assembled as shown in Figure 1.

WORK SAFELY!

Only a **qualified service technician** with proper training should perform this installation. Follow all shop safety rules when performing this installation.

CAUTION

Improper installation of this kit may result in damage to the equipment or cause equipment to malfunction. Carefully follow the procedures outlined in these service instructions.

PREPARATION

1. Make sure the water trailer is turned **OFF** and the engine is cool.
2. Drain the water tank.
3. Place the water trailer on secure, level ground in an area that is free of dirt and debris.
4. Raise the **trailer tongue** (Figure 2) by placing the **trailer tongue jack stand** in the highest position.

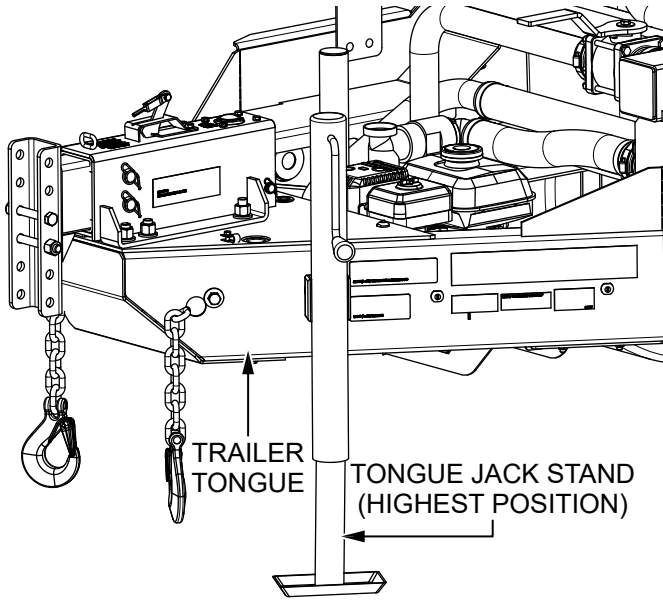

Figure 2. Raise The Trailer Tongue

HOSE AND FITTING REMOVAL

1. Locate the existing hose assembly (Figure 3) located underneath the trailer, near the front of the water tank.

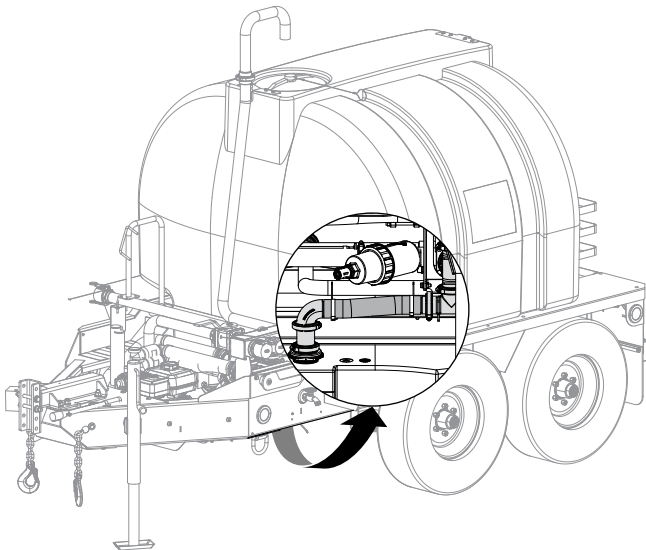

Figure 3. Locate Hose Assembly

2. Loosen the **two hose clamps** (Figure 4) securing the **rubber hose** to the **90-degree elbow** and the **barbed fitting**. Remove and discard the rubber hose and the hose clamps.

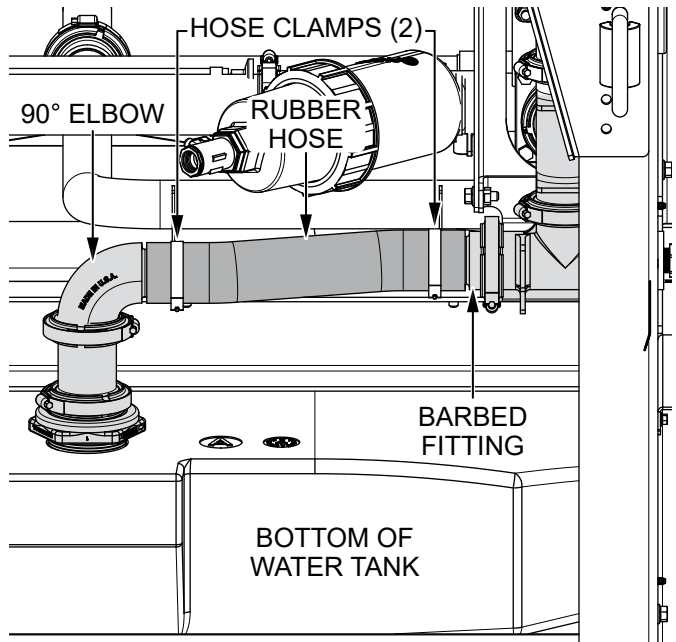

Figure 4. Remove Rubber Hose And Clamps

3. Remove the **worm clamp** (Figure 5) securing the **barbed fitting** to the **tee fitting**, then discard the worm clamp, barbed fitting and **gasket**.

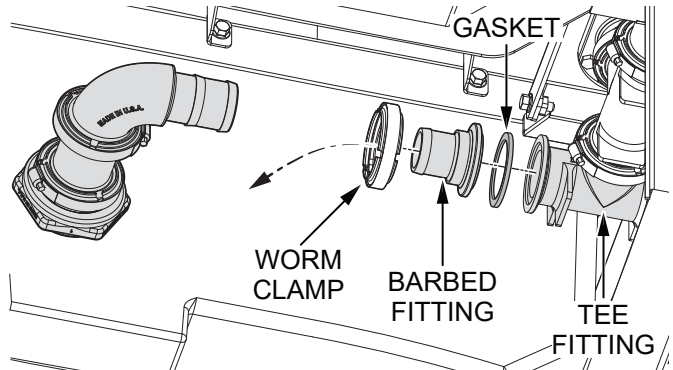

Figure 5. Remove Worm Clamp, Barbed Fitting, And Gasket

VALVE INSTALLATION

1. Place a new **hose clamp (P/N 49783)** onto one end of the new **rubber hose (P/N 49908)**. See Figure 6.

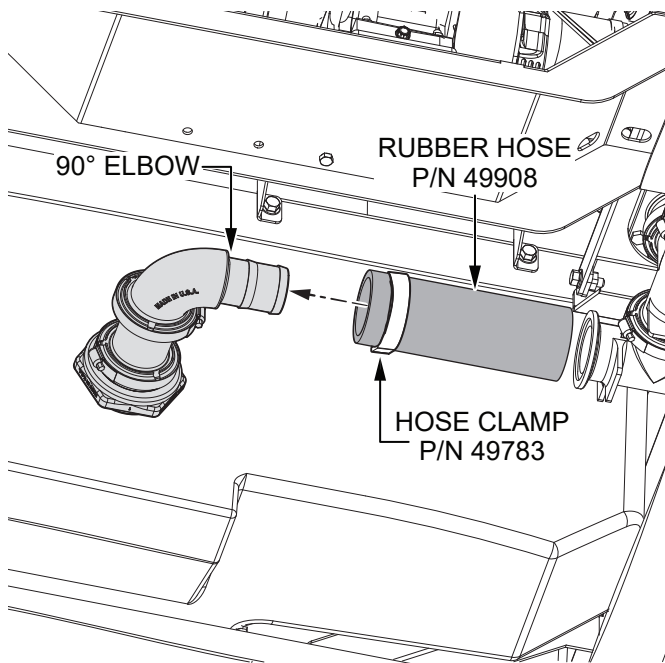

Figure 6. Install Rubber Hose Onto Elbow

2. Place the end of the **rubber hose (P/N 49908)** with the **hose clamp (P/N 49783)** onto the **90-degree elbow**. **DO NOT** tighten the hose clamp at this time. See Figure 6.
3. Place a new **hose clamp (P/N 49783)** onto the open end of the new **rubber hose (P/N 49908)**. See Figure 7.

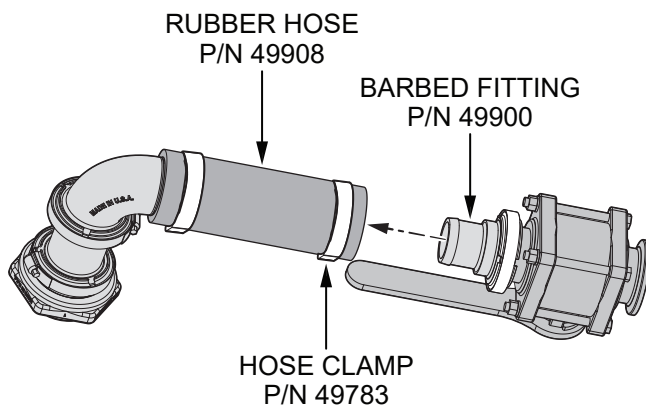

Figure 7. Install Rubber Hose Onto Valve Assembly

4. Slide the **barbed fitting (P/N 49900)** on the pre-assembled portion of the valve assembly into the open end of the **rubber hose (P/N 49908)**. **DO NOT** tighten the hose clamp at this time. See Figure 7.

5. Install the pre-assembled portion of the valve assembly onto the **tee fitting** using the **gasket (P/N 49663)** and **worm clamp (P/N 49664)**, and tighten the worm clamp. See Figure 8.

NOTICE

Make sure the **valve handle (P/N 49907)** is facing the water tank (Figure 8). When placed in the **OPEN** position, the handle should be **parallel** to the ground. When placed in the **CLOSED** position, the handle should be **perpendicular** to the ground.

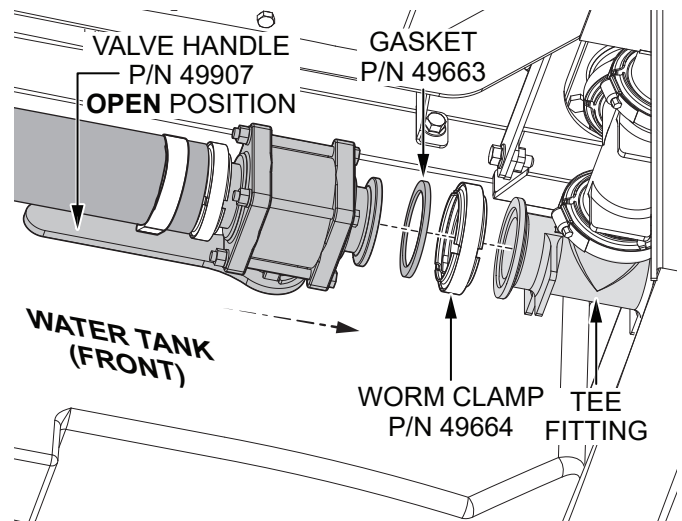

Figure 8. Install Valve Assembly Onto Tee Fitting

6. Fully tighten both **hose clamps (P/N 49783)**.

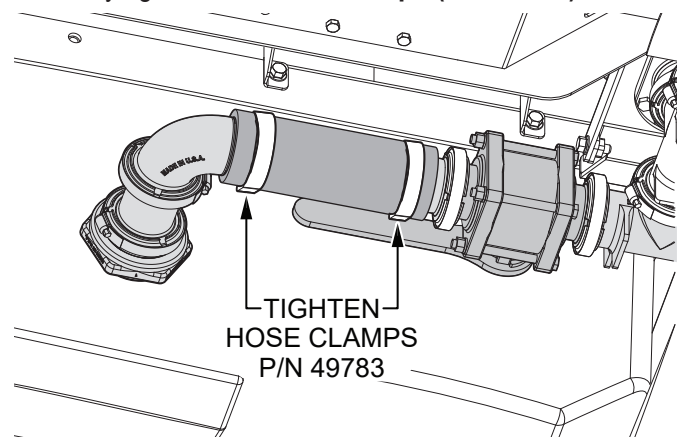

Figure 9. Tighten Hose Clamps

TESTING

1. Place the valve handle in the **OFF (closed)** position.
2. Place a small amount of water in the water tank to test the valve for leaks. The tank does not need to be completely filled.
3. Place the valve handle in the **ON (open)** position and check the valve assembly for water leaks.
4. If water is leaking from the valve assembly, place the valve handle in the **OFF (closed)** position, then make sure all four clamps (Figure 10) are fully tightened.

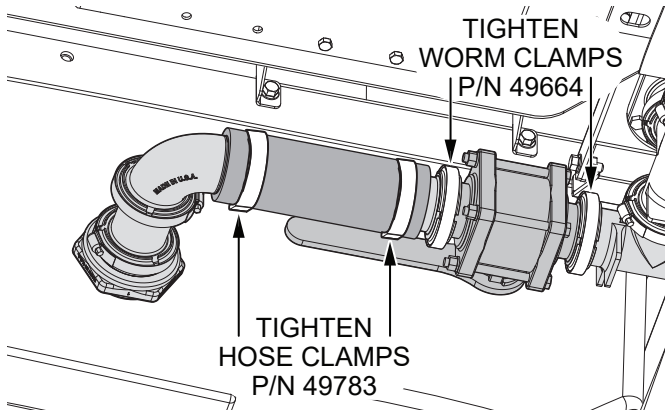

Figure 10. Tighten All Four Clamps

5. If water still leaks from the valve assembly after all clamps have been fully tightened, there is a chance the **gasket** (Figure 8) has moved or did not seat properly during installation. In this case:
 - a. Remove the **worm clamp (P/N 49664)** securing the valve assembly to the tee fitting.
 - b. Make sure that the **gasket (P/N 49663)** in Figure 8 is seated flush within the valve opening, then use the **worm clamp (P/N 49664)** to attach the valve assembly to the tee fitting. Tighten the worm clamp securely.

HERE'S HOW TO GET HELP

UNITED STATES

Multiquip Inc.
(310) 537- 3700
E-mail: mq@multiquip.com

CANADA

Multiquip
(450) 625-2244
E-mail: infocanada@multiquip.com

UNITED KINGDOM

Multiquip (UK) Limited Head Office
0161 339 2223
E-mail: sales@multiquip.co.uk

